

### SCHOTTKY BARRIER DIODE

#### Features

- Low forward voltage
- Guard ring protected
- Small plastic SMD SOD-323 package

#### Applications

- Ultra high-speed switching
- Voltage clamping
- Protection circuits

#### PINNING

PIN	DESCRIPTION
1	Cathode
2	Anode

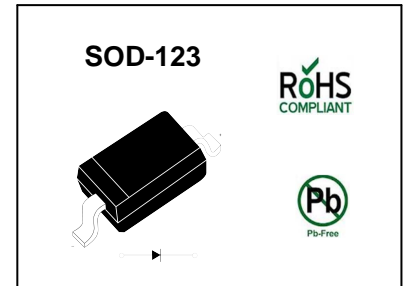

#### Absolute Maximum Ratings ( $T_a = 25\text{ }^{\circ}\text{C}$ )

Parameter	Symbol	Value	Unit
Reverse Voltage	$V_R$	30	V
Forward Current	$I_F$	200	mA
Repetitive Peak Forward Current	$I_{FRM}$	300	mA
Peak Forward Surge Current ( $t_p = 10\text{ ms}$ )	$I_{FSM}$	600	mA
Power Dissipation	$P_D$	230	mW
Thermal Resistance from Junction Ambient	$R_{thJA}$	500	K/W
Junction Temperature	$T_J$	125	$^{\circ}\text{C}$
Storage Temperature Range	$T_{stg}$	- 65 to + 150	$^{\circ}\text{C}$

#### Characteristics at $T_a = 25\text{ }^{\circ}\text{C}$

Parameter	Symbol	Max.	Unit
Forward Voltage at $I_F = 0.1\text{ mA}$ at $I_F = 1\text{ mA}$ at $I_F = 10\text{ mA}$ at $I_F = 30\text{ mA}$ at $I_F = 100\text{ mA}$	$V_F$	240 320 400 500 800	mV
Reverse Current at $V_R = 25\text{ V}$	$I_R$	2	$\mu\text{A}$
Total Capacitance at $V_R = 1\text{ V}$ , $f = 1\text{ MHz}$	$C_T$	10	pF
Reverse Recovery Time at $I_F = 10\text{ mA}$ , $V_R = 6\text{ V}$ , $I_R = 10\text{ mA}$ , $R_L = 100\text{ }\Omega$	$t_{rr}$	6	ns

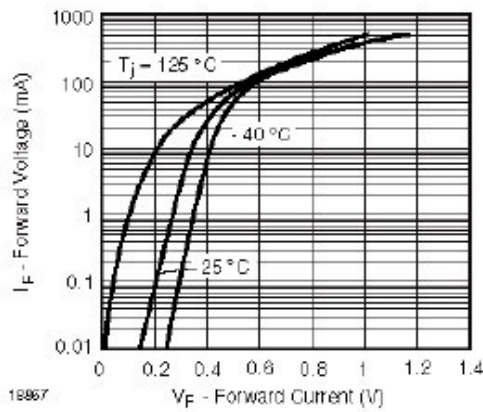

Figure 1. Typical Forward Voltage Forward Current at Various Temperatures

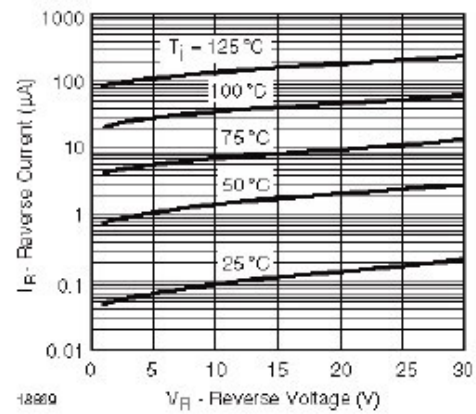

Figure 3. Typical Variation of Reverse Current at Various Temperatures

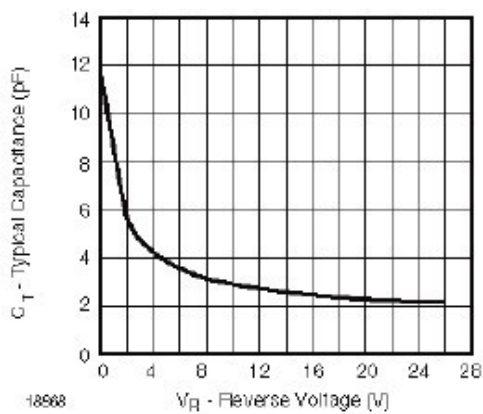
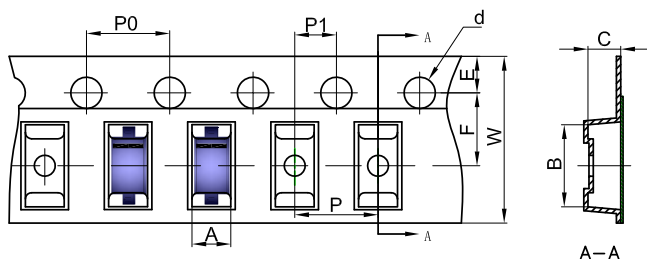

Figure 2. Typical Capacitance  $C_T$  vs. Reverse Applied Voltage  $V_R$

### SOD-123 Tape and Reel

#### SOD-123 Embossed Carrier Tape



Dimensions are in millimeter										
Pkg type	A	B	C	d	E	F	P0	P	P1	W
SOD-123	1.85	3.95	1.57	Ø1.55	1.75	3.50	4.00	4.00	2.00	8.00

#### SOD-123 Tape Leader and Trailer

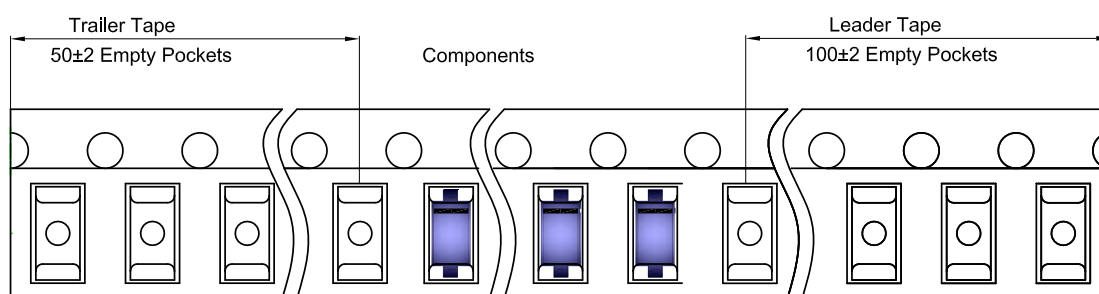

#### SOD-123 Reel

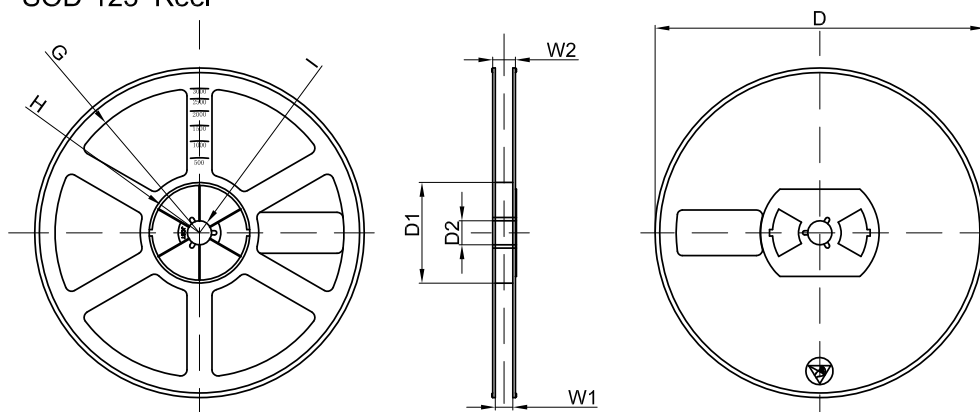

Dimensions are in millimeter								
Reel Option	D	D1	D2	G	H	I	W1	W2
7" Dia	Ø178.00	54.40	13.00	R78.00	R25.60	R6.50	9.50	12.30

REEL	Reel Size	Box	Box Size(mm)	Carton	Carton Size(mm)	G.W.(kg)
3000 pcs	7 inch	45,000 pcs	203×203×195	180,000 pcs	438×438×220	

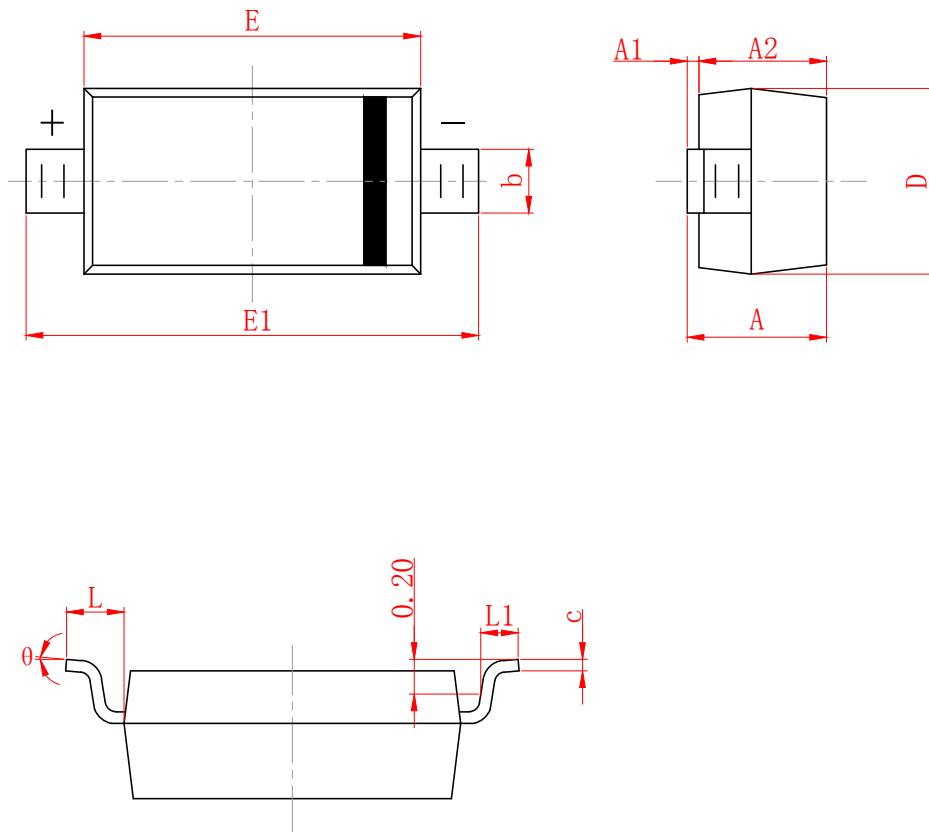

SYMBOL	MILLIMETER	
	MIN	MAX
A	1.050	1.250
A1	0.000	0.100
A2	1.050	1.150
b	0.450	0.650
c	0.008	0.150
D	1.500	1.700
E	2.600	2.800
E1	3.550	3.850
L	0.500 (REF)	
L1	0.250	0.450
θ	0°	8°

## DISCLAIMER

JHG PROVIDES TECHNICAL AND RELIABILITY DATA (INCLUDING DATASHEETS), DESIGN RESOURCES (INCLUDING REFERENCE DESIGNS), APPLICATION OR OTHER DESIGN ADVICE, SAFETY INFORMATION, AND OTHER RESOURCES "AS IS" AND WITH ALL FAULTS, AND DISCLAIMS ALL WARRANTIES, EXPRESS AND IMPLIED, INCLUDING WITHOUT LIMITATION ANY IMPLIED WARRANTIES OF MERCHANTABILITY, FITNESS FOR A PARTICULAR PURPOSE OR NON-INFRINGEMENT OF THIRD PARTY INTELLECTUAL PROPERTY RIGHTS.

These resources are intended for skilled developers designing with JHG products. You are solely responsible for

- (1) selecting the appropriate JHG products for your application;
- (2) designing, validating and testing your application;
- (3) ensuring your application meets applicable standards, and any other safety, security, or other requirements.

These resources are subject to change without notice. JHG grants you permission to use these resources only for development of an application that uses the JHG products described in the resource. Other reproduction and display of these resources are prohibited. No license is granted to any other JHG intellectual property right or to any third party intellectual property right. JHG disclaims responsibility for, and you will fully indemnify JHG and its representatives against, any claims, damages, costs, losses, and liabilities arising out of your use of these resources.